



## Float Switches

### “20A500-MER” Series Double M-Navigator Float Switches

#### Features & Benefits

- Durable Polypropylene ABS Body Construction
- Mercury Type Switch Actuation
- Wide Angle (90° Operating Range)
- Large Drawn Down Range:
- Pump Duty Rated
- Available in 120V or 240V models
- Max. ratings:  
For 120V model: 1HP, 15 F.L.A. maximum  
For 240V model: 2HP, 15 F.L.A. maximum
- Available with or without Piggyback plug
- Available in Pump Up or Pump Down Configurations
- Available w/SST Pipe Clamp or Cable Tie
- Multiple Cord Lengths Available

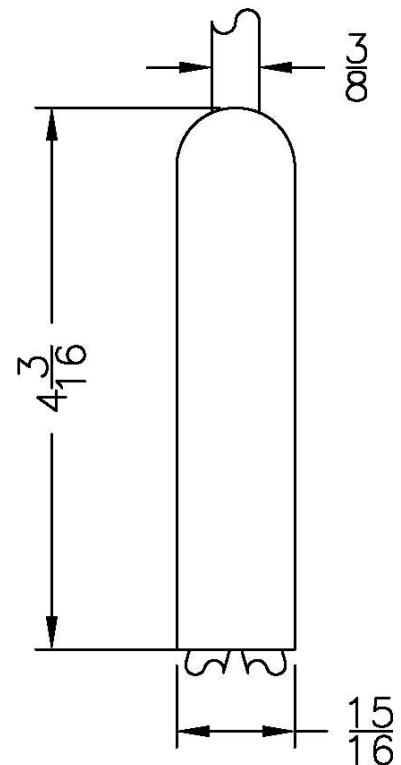
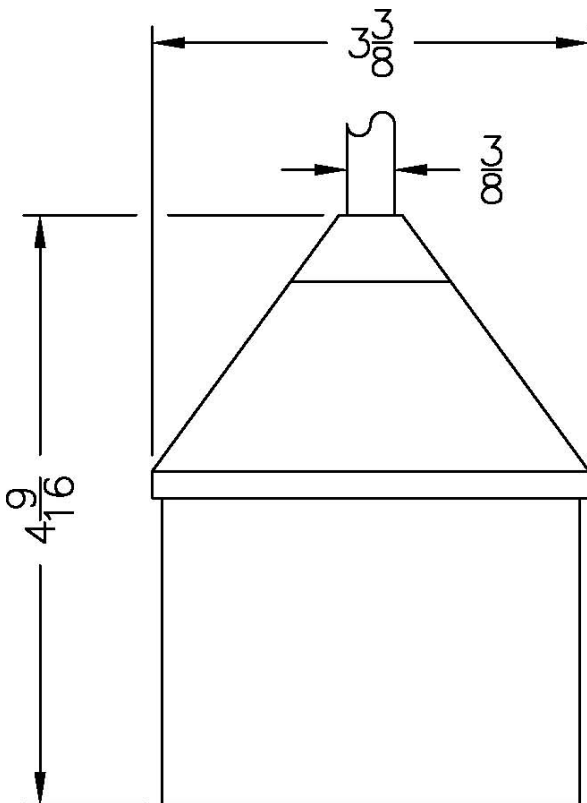

\*Note: Consult the factory for other available options. Not Recommended for Potable Water Applications.



# Float Switches

## “20A500-MER” Series Double M-Navigator Float Switches

### Typical Installation

#### **NOTE:**

Float switch voltage must be selected to match the pump and incoming power voltage.

